



TM

VENIERI
SPA

2.63D

Plus

WHEEL LOADER





LITTLE BIG ONE.

REDUCED SIZE, UNSTOPPABLE POWER



Increase your expectations: Venieri's small one is here!

Thanks to the widely tested project evolution matching the new market requirements, the new machine represent a significant improvement. We are located in the "Motor Valley" which, in a small territory, has always been giving birth to fabulous cars and top performing motorbikes!

The genetic heritage is very rich: the **Japanese technology** of the **Kubota engines**, **new Bosch Rexroth transmissions** and a **ratio traction/weight** never before achieved.

The **ORA** (oscillating rear axle) is one of the main organs in this series: **there isn't any oscillating mechanical coupling** between the front and rear, ensuring smart working and driving safety on this small one which can be normally found on big machines only.

Plus
2.63D

- › "Z" Linkage
- › Max power **53 HP**
- › Bucket capacity **0.98 yd³**
- › Max permis. weight **12,456 lb**
- › Std operat. weight **9,590 lb**

ENGINE: JAPANESE TECHNOLOGY

The **Kubota D1803-CR-T-E5** engine complies with **Tier 4f** - strict regulations. Advanced **particulate filter technology (DPF)** of the **latest generation**, enables an automatic regeneration even at low rpm and allows **appreciably maintenance intervals reductions** thus ensuring operational **continuity. Quietness, durability and efficiency** are guaranteed by the **Common Rail** system capable to optimize combustion maximum efficiency. A clean, flexible engine with top performances.



TRANSMISSION: GLOBAL QUALITY

There are many ways to transmit power but only one is able to satisfy even the most demanding customers: **Venieri** and **Bosch-Rexroth** laboratories have studied and developed **one of the best possible combinations of high pressure transmission** (so **high efficiency transmission with 7,252 psi**). In that way the **efficiency** of Venieri's wheel loaders led to a **11% improvement**: try and you'll believe it!

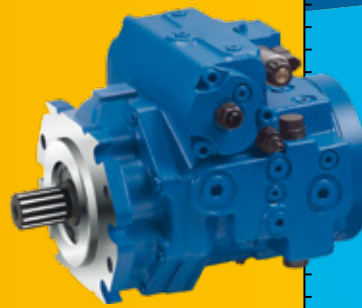

Extended performance range

Tractive Force F [lb]

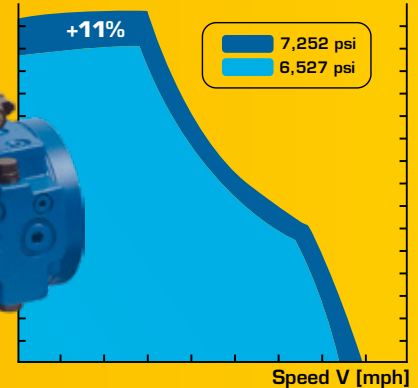

AXLE: TOP LEVEL EQUIPMENT

The **double fixing** on each side grants **extreme reliability and stiffness to the chassis even after 8000/10000 working hours** and represents a further confirmation of our design philosophy: **small size machines equally designed as the big ones!** The **18° rear oscillation** grants perfect **stability and security** during working and transfer operations. Electrically driven **100% blocking slip differential**.



GREASING: CENTRALIZED COMFORT

Maintenance is fundamental on all machines: Venieri decided to build machines **easy and accessible to anyone**: machines whose maintenance operations can be carried out in an **easy and safe way**, thanks to its particular design. For example, the **3 points of centralized greasing** allow the **rear axle** and the **swinging** to be instantly double checked.





80° articulation.

Cramped conditions do not scare us.

Steering console.

A master piece for all job requirements!



Arms Connection with ovalized section.

We want to see clearly!



Framed glass door and flat glass.

We combine style with efficiency!

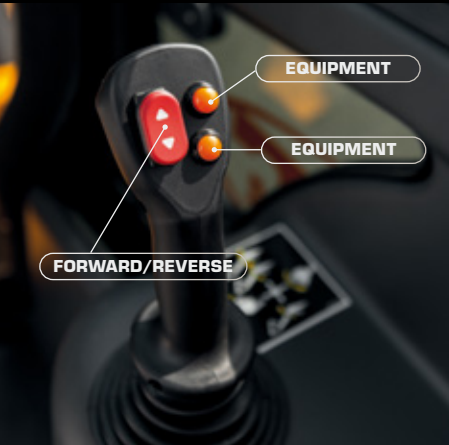

Multipurpose Joystick.
You can do everything with one hand!

Hydraulic quick coupling.
Use your Venieri as a universal tool carrier thanks to the interchangeability of most quick couplings/equipment!

Linkage connection on the chassis with cantilevered pins.
+ performance, better visibility
= less risk!



Evolved and complete hydraulic.
Not only High Flow kit but also additional hydraulic kit for tools and equipments. An example? Hand operated hydraulic demolition hammer!



2.63D Plus

WHEEL LOADER / "Z" LINKAGE



DIESEL ENGINE

Engine: 3 cylinder in line engine, turbocharged, common-rail injection with electronic control, exhaust gas recirculation EGR, water cooled, dry filtration, diesel oxidation catalyst (DOC), diesel particulate filter (DPF). Emissioned according to CE 97/68 - Tier 4f

Type	Kubota D1803-CR-T	
Max Power	39kW - 53 HP	
Rated rpm	2.700	
Power ISO/TR 14396	37 kW - 50 HP	
Power EEC/80/1269	35,3 kW - 47 HP	
Max. torque	lbf ft	111
Bore	in	3.43
Stroke	in	4.03
Displacement	in ³	111,43



ELECTRIC SYSTEM

Battery	12 Volt	
Capacity EN 60095-1	80 Ah - 770 A	
Alternator rating	60 A	
Reverse warning	Standard	
Wiring according to rules	IP 67 e DIN 40050	



TRANSMISSION

Hydrostatic transmission with automatic power regulation and closed circuit with variable-displacement pump and engine. Two forward/reverse speeds with single-lever control.

	forward	reverse
1 st Gear mph	0÷5	0÷5
2 nd Gear mph	0÷18	0÷18



AXLES

All wheel drive. Two heavy duty axles with planetary final drives on each wheel. Fixed rigid drive axle on front chassis section. Oscillating drive axle on rear chassis section up to a 20° total angle. Transfer gearbox allowing the rear and the front movement by means of a transmission shaft. Self-locking limited slip differential on front axle (optional on rear axle).



BRAKES

Service: drum-brake hydraulically operating on front axle working on all wheels. Parking brake: mechanical drum-brake operating on service brake, manually activated.



TYRES

Standard	12.0/75-18 12pr	
Optional	10.5-18 10pr • 12.5-18 10pr • 15.5/55 R18	



STEERING

Servo assisted hydraulic steering with LOAD SENSING system.

Total steering angle	80°	
Inner tyres turning radius	ft in	7'2.34"
External tyres turning radius	ft in	12'5.21"
External bucket turning radius	ft in	13'9.75"



HYDRAULIC SYSTEM

Hydraulic gear pump with LOAD SENSING priority valve for steering circuit. 2-section modular control valve with main relief valve. Double-acting hydraulic cylinders. Hydraulic oil cooling radiator. Full-flow oil filter on the return circuit. Single control cloche-lever with 4-position bucket lifting system and 3-position auxiliary control system.

Max flow	gpm	15.85
Loader relief valve pressure	psi	3,336
Steering relief valve pressure	psi	2,756
Lift cylinder	ft in	2.76x36.89
Bucket cylinder	ft in	3.15x15.55



SERVICES CAPACITIES

Engine	gal	2.11
Front axle	gal	1.53
Rear axle + gear box	gal	1.72
Hydraulic circuit	gal	15.06
Brake system	gal	0.29
Fuel	gal	18.49
Water cooling	gal	2.64



TECHNICAL FEATURES

Standard bucket capacity	yd ³	0.98
Bucket width	ft in	5'6.93"
Straight static tipping load	lb	7,275
Full turned 40° tipping load	lb	6,614
Lifting capacity at max. height	lb	6,834
Dump clearance	ft in	10'2.05"
Dump height at 43°	ft in	8'0.46"
Reach at 43°	in	25.59
Breakout force	lb	11,684



DIMENSIONS AND WEIGHT

Max length in transfer position	ft in	15'8.98"
Max width in transfer position	ft in	5'6.93"
Max height	ft in	8'0.85"
Track width	ft in	4'3.97"
Overall tyre width	ft in	5'4.57"
Wheel base	ft in	6'4.77"
Ground clearance	in	14.57
Standard operating weight	lb	9,590
Max weight	lb	12,456

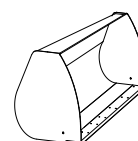
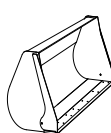
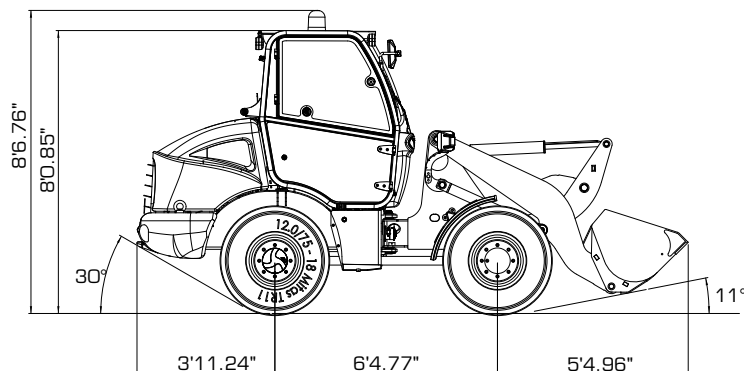
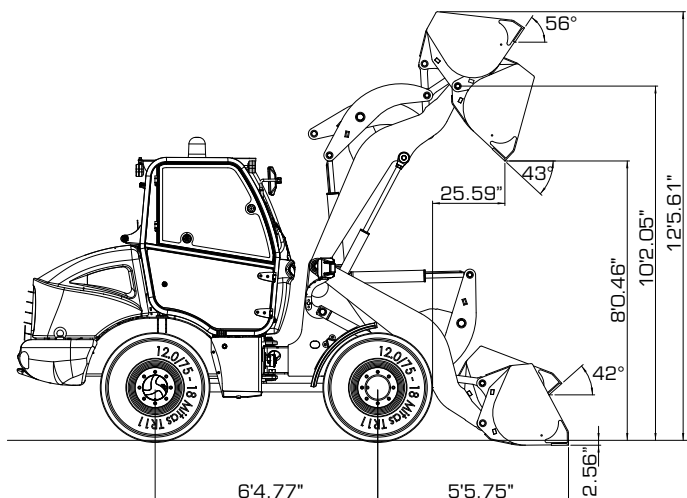

PERFORMANCE DATA

		UNIVERSAL BUCKET	MULTI PURPOSE BUCKET	OVERSIZE	FORKS
Full load bucket capacity (SAE)	yd ³	0.98	0.78	1.57	/
Bucket width	ft in	5'6.93"	5'6.93"	6'2.8"	/
Bucket weight	lb	551	772	772	/
Max operative height	ft in	12'5.61"	12'3.64"	12'7.57"	/
Forks length (Standard)	ft in				3'3.37"
Forks length (Optional)	ft in				3'11.24"
Height to hinge pin	ft in	10'2.05"	10'2.05"	10'2.05"	/
Dump angle	°	43°	43°	43°	/
Dump height	ft in	8'0.46"	8'2.43"	7'10.49"	/
Reach fully raised	in	25.59	23.62	27.56	/
Max dump distance	ft in	4'9.09"	4'7.12"	4'11.06"	/
Bucket static tipping load, straight	lb	7,275	7,055	6,393	/
Bucket static tipping load, full turn (40°)	lb	6,614	6,393	5,952	/
Forks static tipping load, full turn (40°)	lb				5,291
Forks Payload EN 474-3 (80%)	lb				4,233
Forks Payload EN 474-3 (60%)	lb				3,175
Breakout force	lb	11,905	12,787	11,244	/
Total length	ft in	15'8.98"	15'7.01"	15'8.98"	/
External bucket turning radius	ft in	13'9.35"	13'1.48"	14'1.29"	/
Standard operative weight	lb	9,590	10,361	10,361	/

TRANSMISSION

% Traction/Weight	71 %
Pump	7,252 psi
Hydrostatic engine	7,252 psi



Venieri
ORIGINAL
SPARE PARTS

EQUIPMENT

2.63D Plus

› Acoustic warnings	•
› Plugs with keys for fuel and hydraulic tanks	•
› Bucket with bolted teeth	•
› ROPS-FOPS cab with heating and pressurization fan, with front and rear windscreen wiper and windshield washer	•
› Tool box	•
› Spare parts catalogue	•
› Seat belt	•
› Electrically driven 100% blocking slip differential on front axle	•
› Safety clamp for lifting cylinders	•
› Visual index for bucket position	•
› Working lights	•
› Draw bar hook	•
› Soundproofing	•
› Yellow rotating and overturning beacon	•
› Operation and maintenance manual	•
› Type-approval for road traffic	•
› Side rearview mirrors	•
› Complete instrument panel	•
› Hydraulic or mechanical quick couple	0
› Cement mixing bucket	0
› Multi-purpose 4 in 1 bucket	0
› Speed reduction kit	0
› Lifting forks	0
› Proportional self lock rear differential	-
› Electrically driven 100% blocking slip differential on front axle; open on rear axle	-
› Asphalt and cement planer	0
› Snow blower	0
› "V" type snow blade	0
› Angle-tilt dozer blade	0
› Hand operating hammer	0
› Polishing brush	0
› Trencher	0

• Standard ◻ Optional - Not available



www.venieriamerica.com



Via Piratello, 106 - 48022 Lugo (RA) - ITALY
Tel. +39 0545 904411 Fax +39 0545 30389
e-mail: info@vf-venieri.com | www.vf-venieri.com

Spare Parts

Tel. +39 0545 904429 Fax +39 0545 24555
e-mail: ricambi@vf-venieri.com